



Palisades Charter Elementary School Reconstruction Project

Design Concepts Community Meeting

June 4, 2025

Agenda

- Welcome
- Meeting Logistics
- Community Relations Engagement Plan
- Campus Reconstruction Projects
- Palisades Elementary School Project Scope
- Anticipated Timeline
- Preliminary Design Concepts
- Questions

FSD Community Relations Engagement Plan for the Design Process

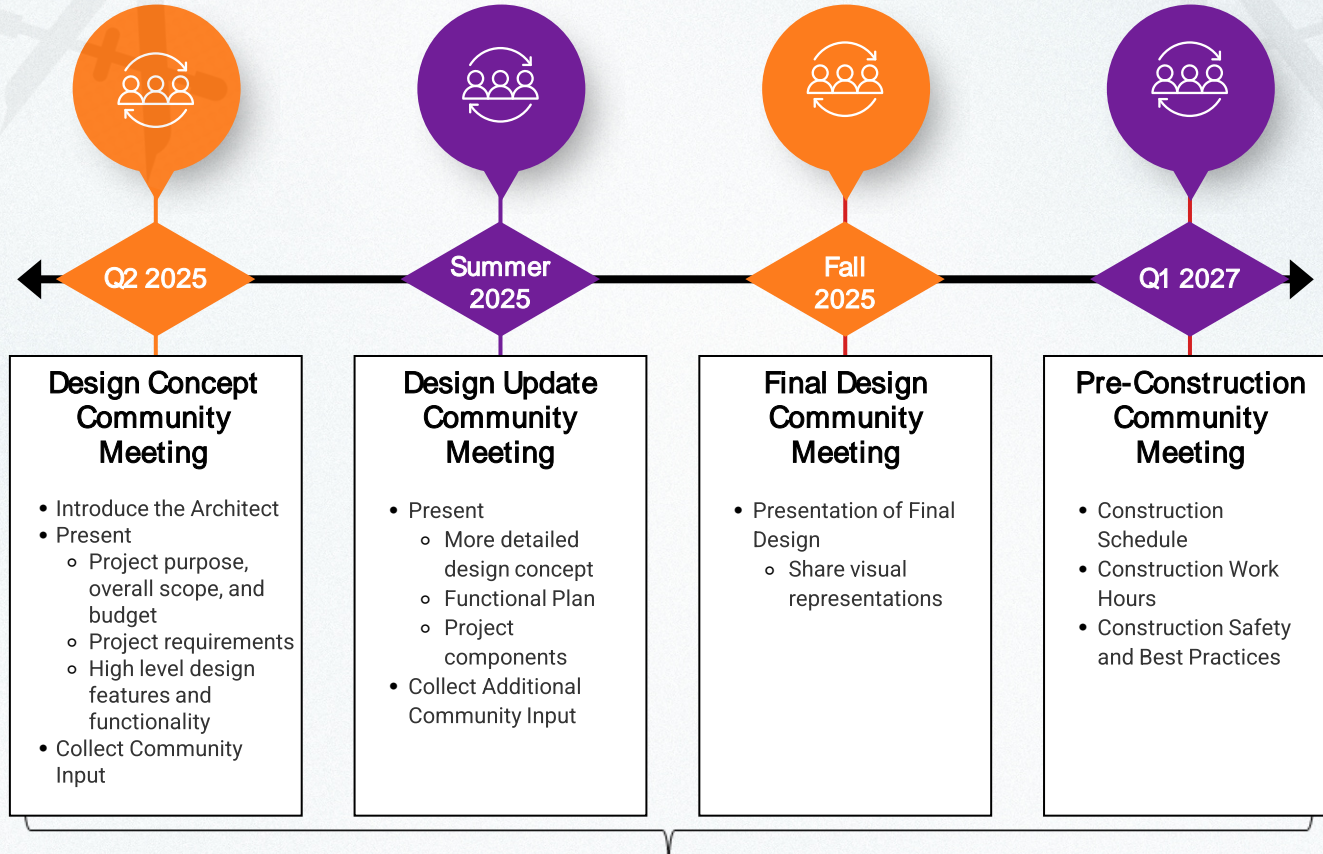

Campus Reconstruction Projects – Summary

- The January 2025 Palisades Fire caused an unprecedented loss of facilities due to fire damage, with significant impacts to Marquez Charter Elementary School, Palisades Charter Elementary School, and Palisades Charter High School.
- The proposed Projects have been developed to expedite the repopulation of the affected schools.
- These Projects replace facilities that were destroyed at each school.
- The proposed Projects for **Palisades Charter Elementary School and Marquez Charter Elementary School** will be funded by the category of need for major modernizations, upgrades, and reconfigurations to school campuses.
- Board Approved June 3, 2025.

Palisades CES Proposed Project

Project Scope:

- Restore and repair intact buildings with upgrades for reoccupancy (equipment, systems, interiors)
- 16 new classrooms (general, TK/K, specialty), admin spaces, multipurpose room, and maintenance facilities
- Infrastructure renewal including utilities, landscape, and parking improvements

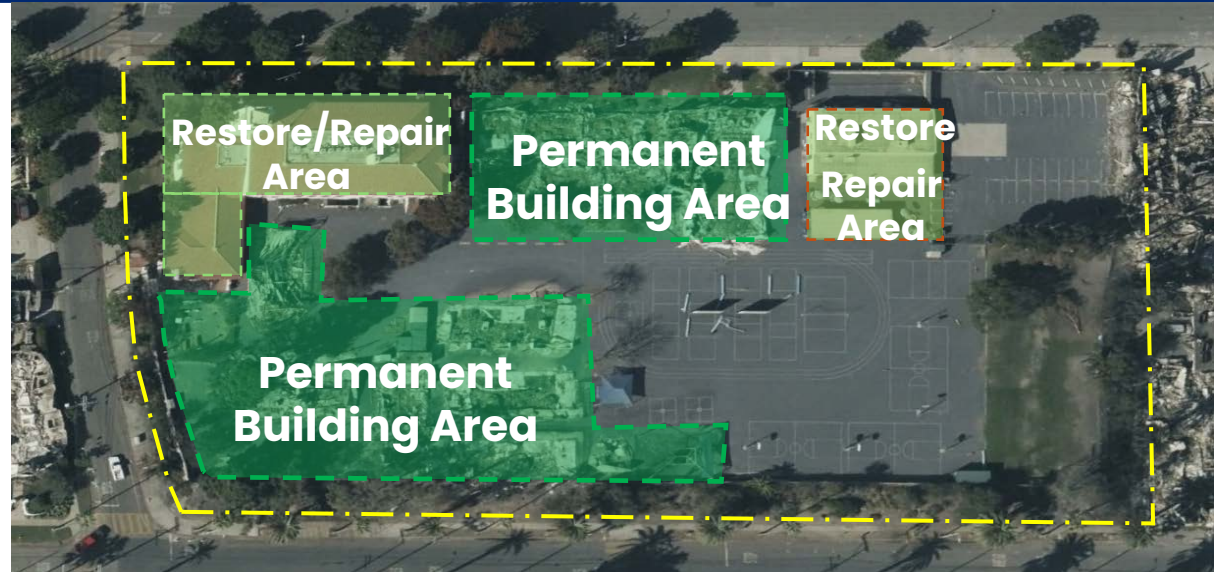

Total Project Budget ~\$134.9M

Anticipated Schedule

- | | |
|---|---------|
| • Restoration/Repair Construction Start | Q2 2025 |
| • New Building Construction Start | Q1 2027 |
| • Construction Complete | Q4 2028 |

Permanent Campus Program Overview

- New Classrooms
 - 9 General Classrooms (1st – 5th Grade)
 - 5 Kinder/TK
 - 2 Flexible Learning/Maker Space Classrooms
- Classroom Support Spaces
 - Collaboration Spaces, Teacher Workrooms, Storage, etc.
- 2 Resource Specialist (RSP) Rooms

Permanent Multi-Purpose Room

- Larger than the Auditorium (~3,000 square feet)
- More Seating (~400 seats)
- Can be used for Indoor Dining (~240 seats (*built-in folding tables and benches*))
- More Storage
- Pipe Grid Stage lighting and Built in projector with motorized projection screen
- Exterior roll up door at the back of the stage
- Flat floor allows for hosting events including book fairs, science fairs, meetings, etc.
- Use for PE during inclement weather

Anticipated Reconstruction Timeline

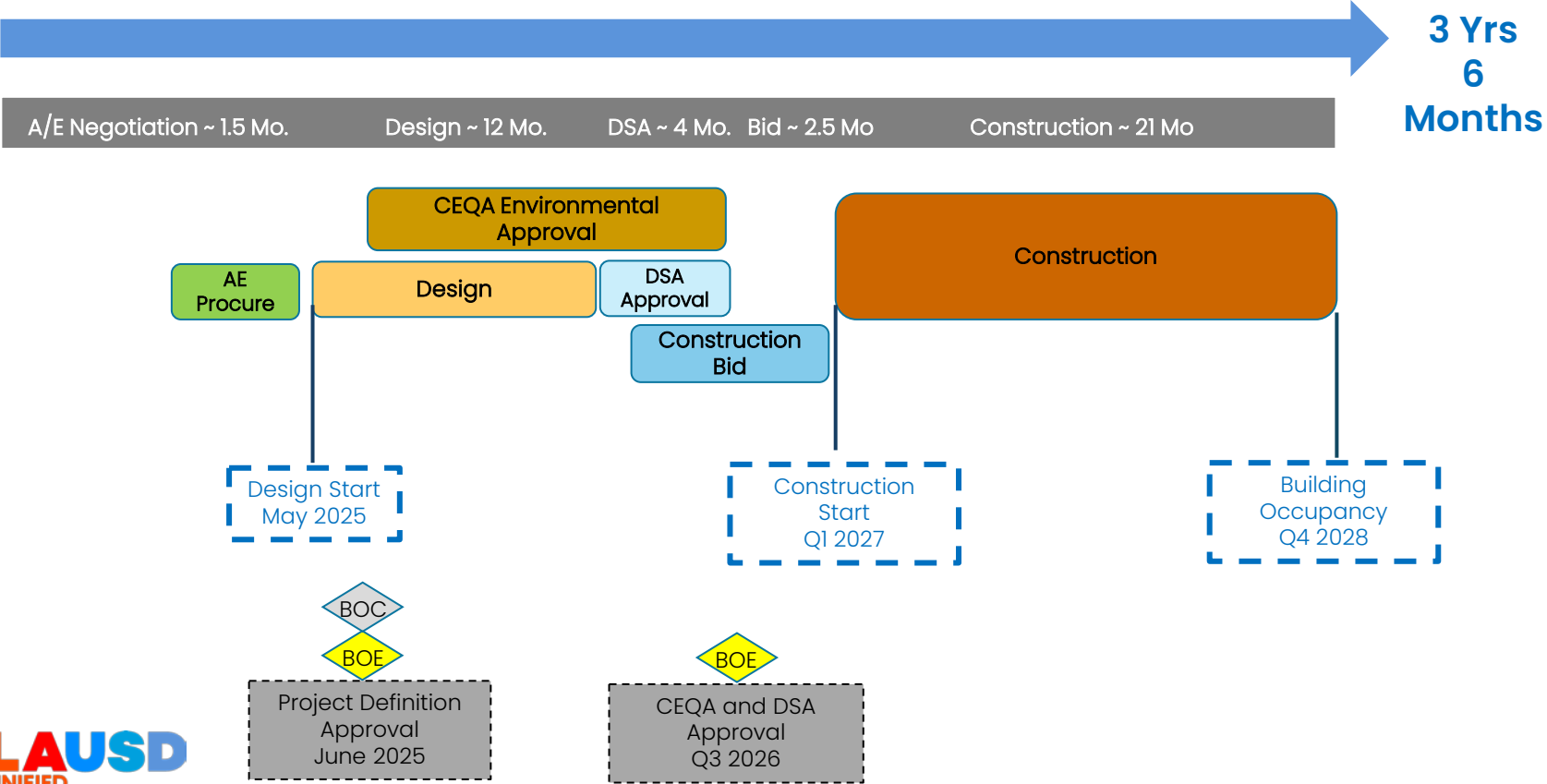

12-Month Design Milestones Overview

Preliminary Schematic Design Phase: ~2 months:

Initial Phase including continuing Due Diligence and Site Analysis, Programming, and development of initial design/massing options.

Community Meeting #1

Final Schematic Design Phase: ~2 months :

Development of site and floor plans, building massing, initial development of building engineering systems, and exterior environment for recommended Design Option including preliminary interior and exterior renderings.

Community Meeting #2

Design Development Phase: ~3 months :

Refinement of the Design with detailed plans, sections, elevations, and material and color selections. Development and Coordination of work by project engineers.

Community Meeting #3

50% Construction Document Phase: ~2.5 months :

Initial Construction Documentation development of plans, details, specifications as required for agency permitting and construction. Technical Reviews by LAUSD Staff to ensure compliance of design with LAUSD Standards.

100% Construction Document Phase: ~2.5 months

Final Construction Documentation development of plans, details, specifications as required for agency permitting and construction. Submittal to the Division of the State Architect (DSA) for Plan check Approvals at the Conclusion of this Phase.

Practice



Palisades Charter Elementary School Reconstruction

Los Angeles Unified School District

Preliminary Schematic Design, Staff & Community Meetings

03 and 04 June 2025



WE are Practice

We Practice to co-create environments that affect social change through design-forward thinking.

For everyone.



Co-Creation

to work in partnership with openness, honesty, and transparency for greater impact.



Inclusive Impact

to bring along everyone, not just some.



Holistic Sustainability

to effect social, environmental, and economic good.



Joy

to create spaces where everyone thrives through forward-thinking ideas and design.

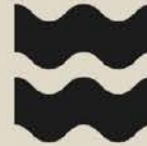

Listening

to fuel our culture and design through empathy, curiosity, and research.



Optimism

to innovate design within real-world constraints.

Educating the Next Generation

With a focus on inclusive design, we craft environments that embrace diverse learning styles and empower every student.

We design spaces to not only promote academic success, but to spark curiosity, inspiration, and joy.







Hongjoo Kim Landscape Architects works to harmonize humans and nature. We believe open space is the pinnacle of democratic practice where everyone, regardless of their origin, color, religion and interest, can be together to share their thoughts and experience.

Principles & Focus Areas:

- Collaborative Design Process
- Contextual Exploration of Landscape Art
- Innovative Urban Ecology
- Harmony with Nature
- Sustainable Design Techniques
- Water Conservation
- Stormwater Management



Enough about us.....
Let's talk about YOU!

First Day of Palisades Elementary (September 23, 1923)
Courtesy of Santa Monica Public Library Archive Images

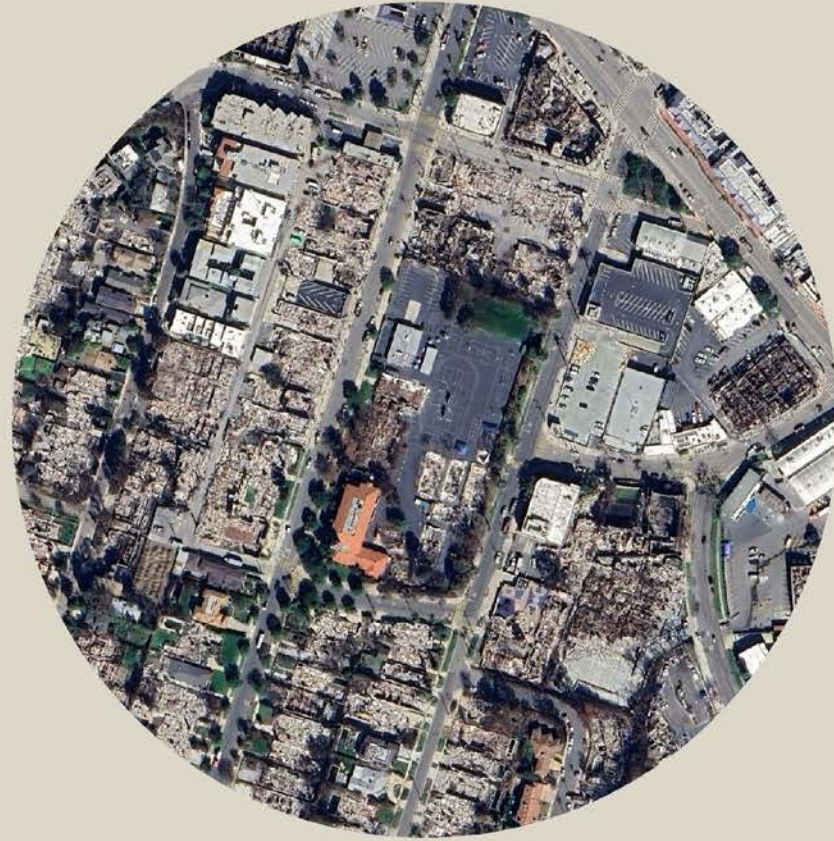

What We've Heard from You (so far!)

Maximize Open Space and Connectivity on a Constrained Site while Creating Varied Experiences.

Restore a Community Resource and Social Anchor for Students, Teachers and Parents.

Construct a Resilient School for Future Generations.

Respect the Historic Resource while promoting a Forward-Looking Vision.

This Led Us to.....

Guiding Principles

Establish a Framework Plan that Promotes Unity + Identity for Students, Teachers and Community.

Create an Environment that Supports Healing and Collective Memory.

Utilize Holistic Design Practices to Create a Resilient Campus (environmental + cultural).

Harmonize the New Structures with the Existing Building.

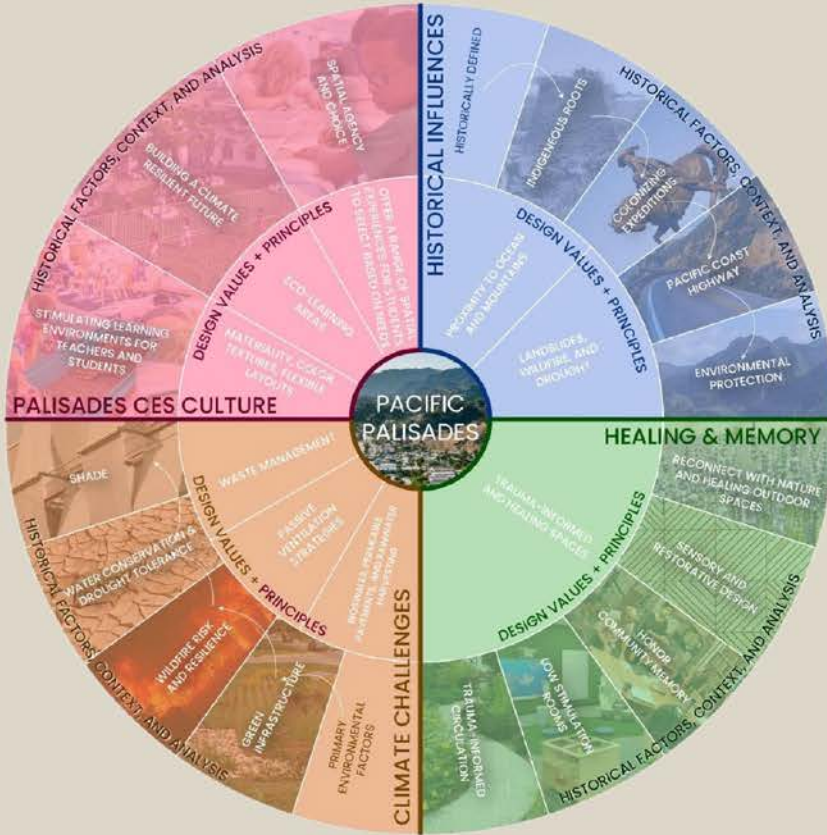



Historical Influences

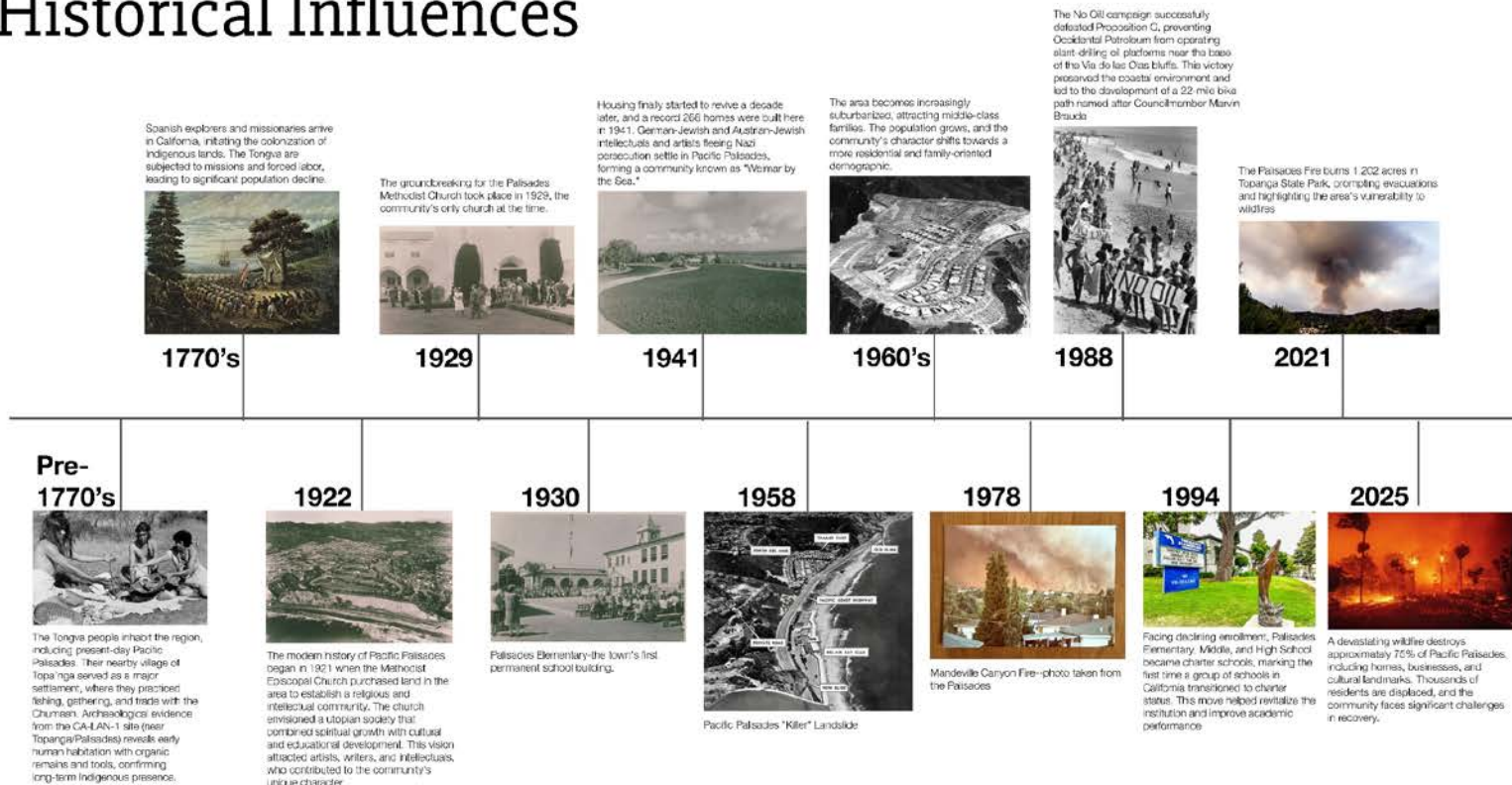



Historical Influences



1930

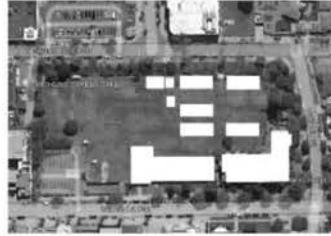

1952



1964



1972



1989

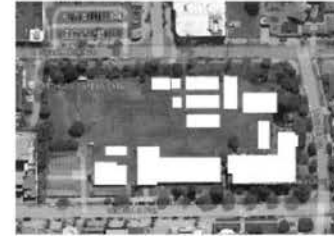

2024



Historical Influences



Arcades & Loggias



Porches



Decorative Tile & Craft

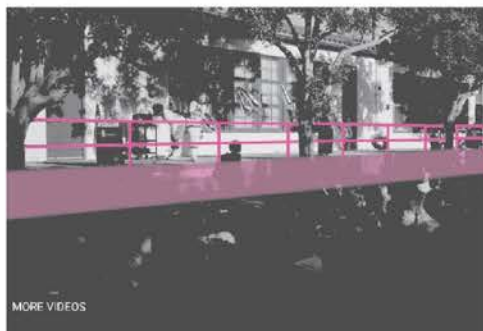

Elevated Walkways / Stages

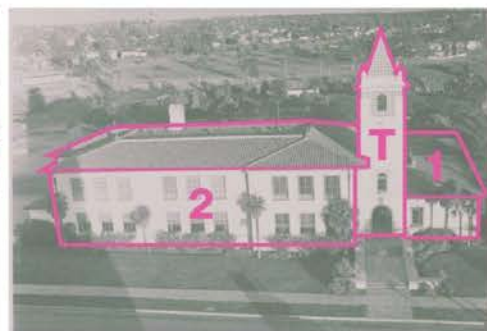

Varied Massing & Scale



Healing and Memory



Healing, Sensory, and Learning
Gardens



Memorials & Remembrance



Connections



Supportive Environments





Climate Challenges

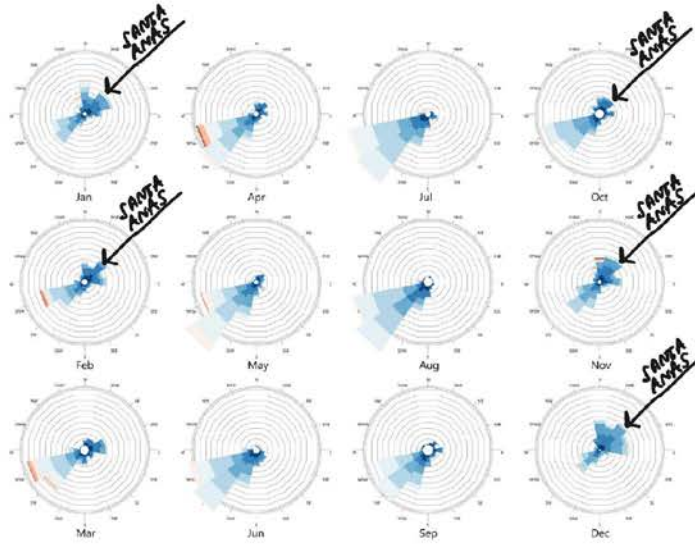

Wind

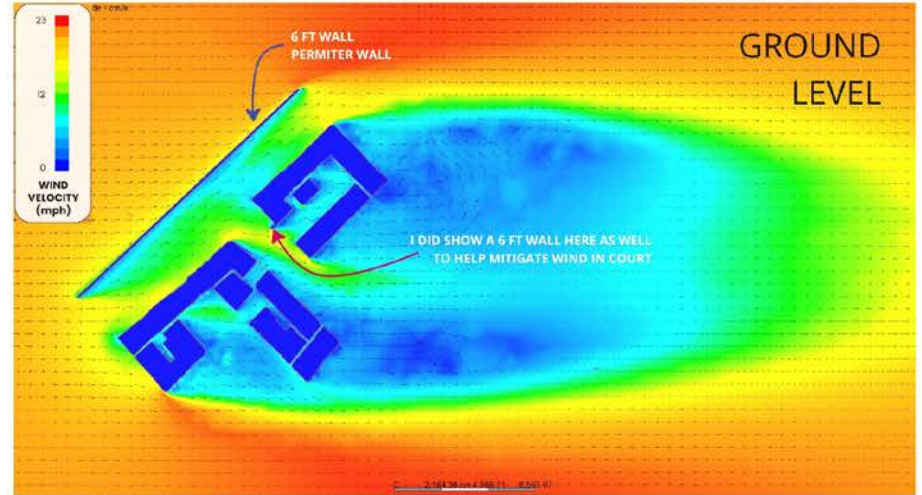

Wind Analysis



Palisades CES Culture



Images from Get to Know Palisades Charter Elementary School Video on School Website



Events from Palisades Charter Elementary School Calendar

Site Analysis and Initial Concepts

Site Analysis

- Access & Pickup / Dropoff Zones
- Tree Inventory
- Edge Conditions / Grade
- Site Diagram

Initial Site Concepts

- Community Commons
- Interwoven Landscapes
- Garden Courts



Access & Pickup/Dropoff Zones

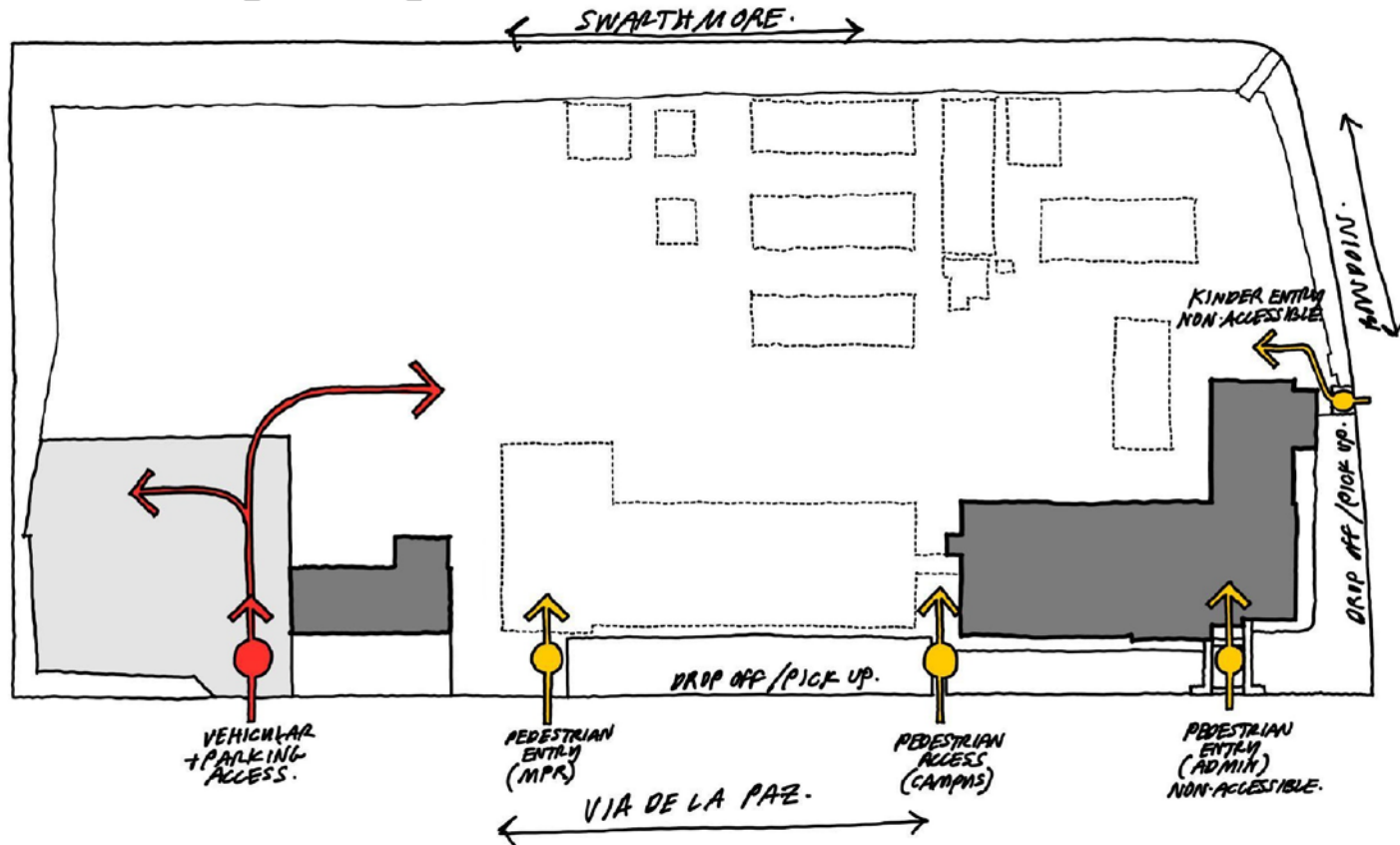

Tree Inventory



Edge Conditions / Grade

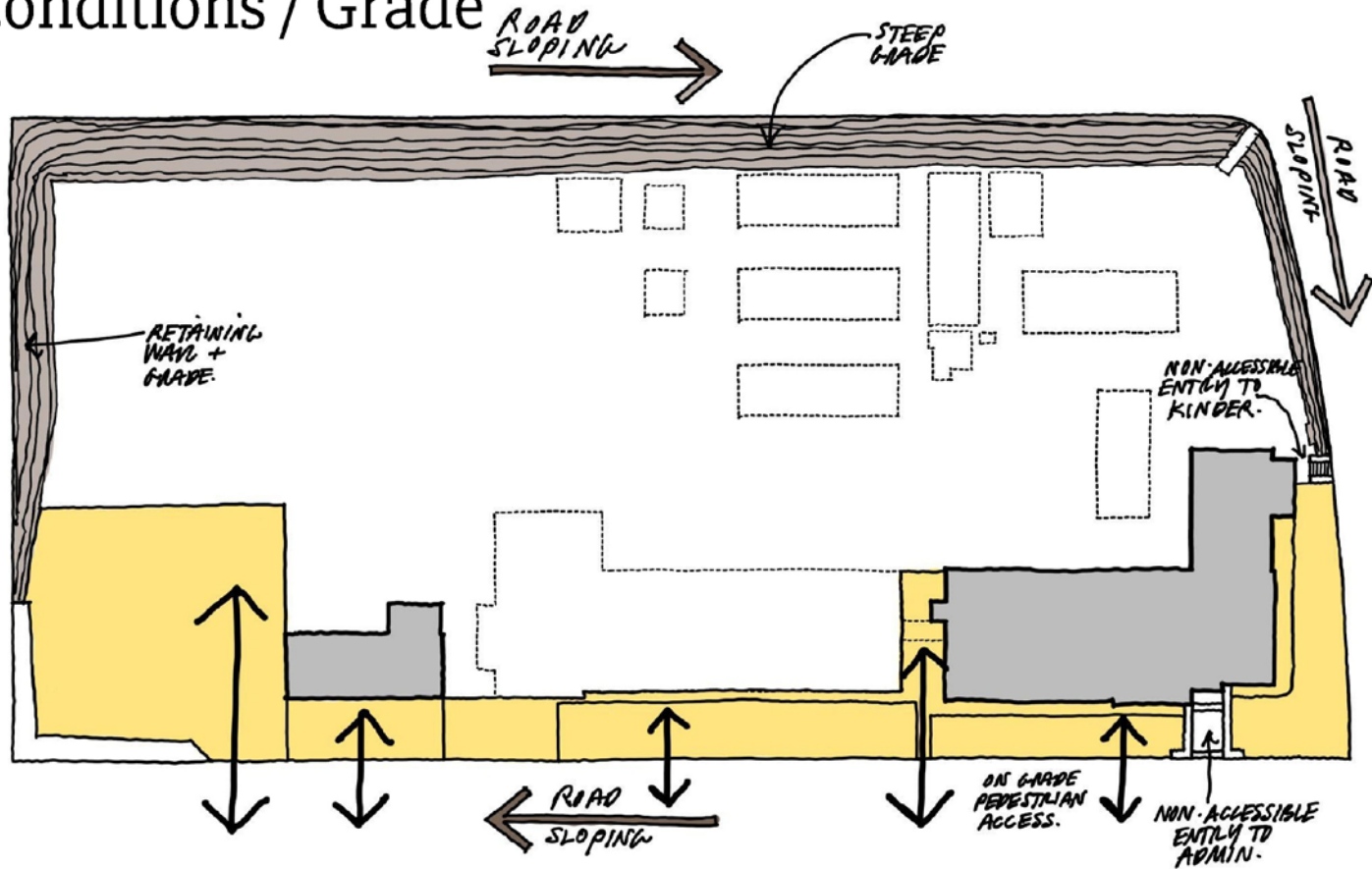

Site Diagram

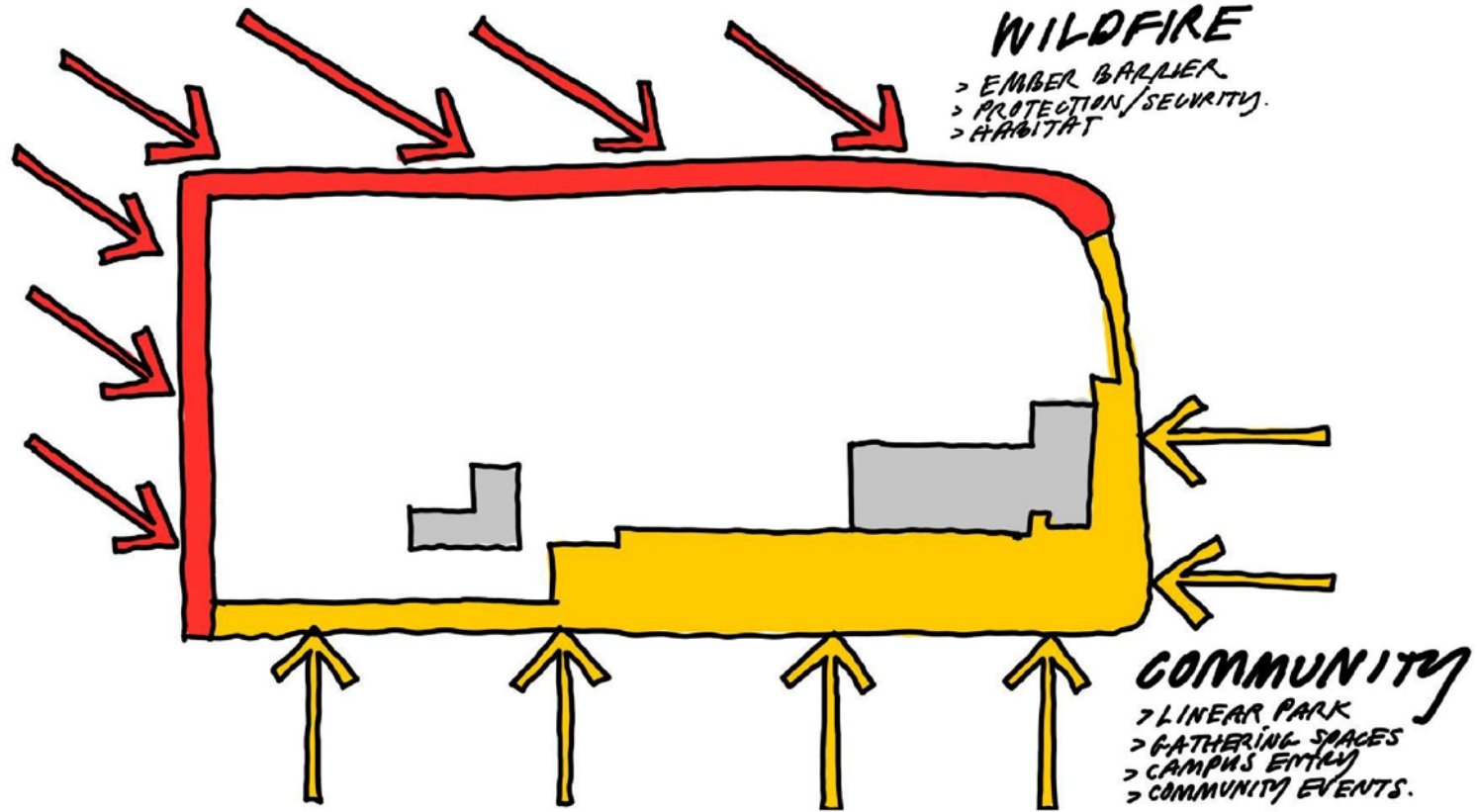

3 Site Approaches

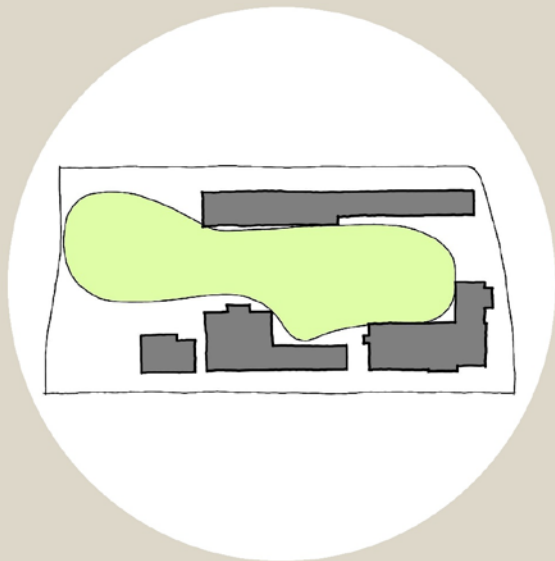

Community Commons

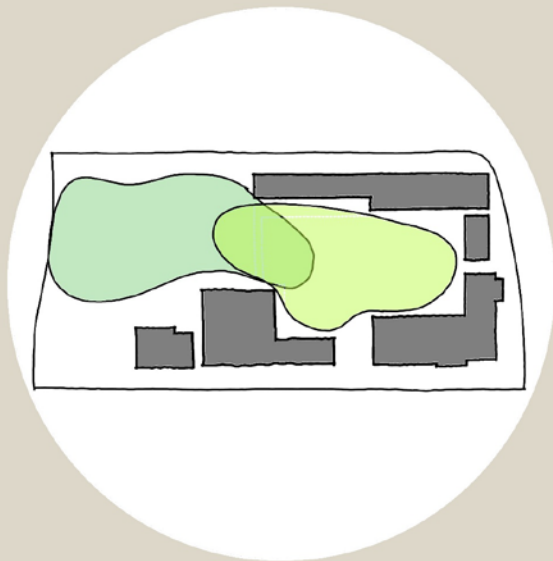

Interwoven Landscapes

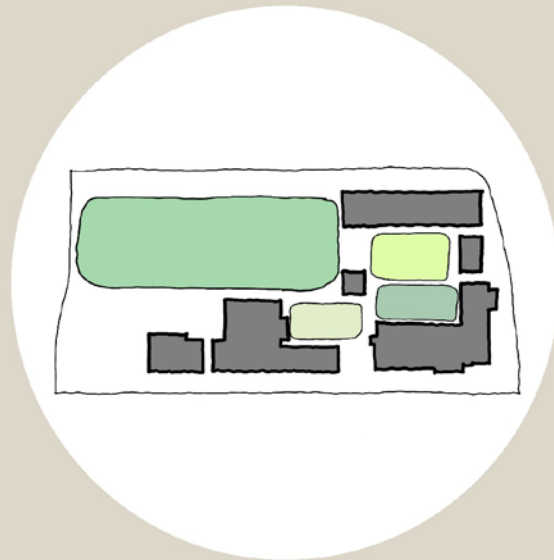

Garden Courts

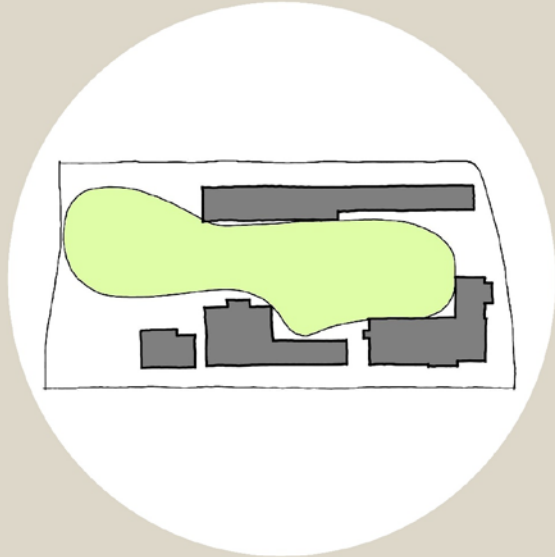

Scheme 01

Community Commons

2-Story Linear Building

One Big Open Space

Singular Campus Entry along Via De La Paz



Scheme 01 - Inspirational Images

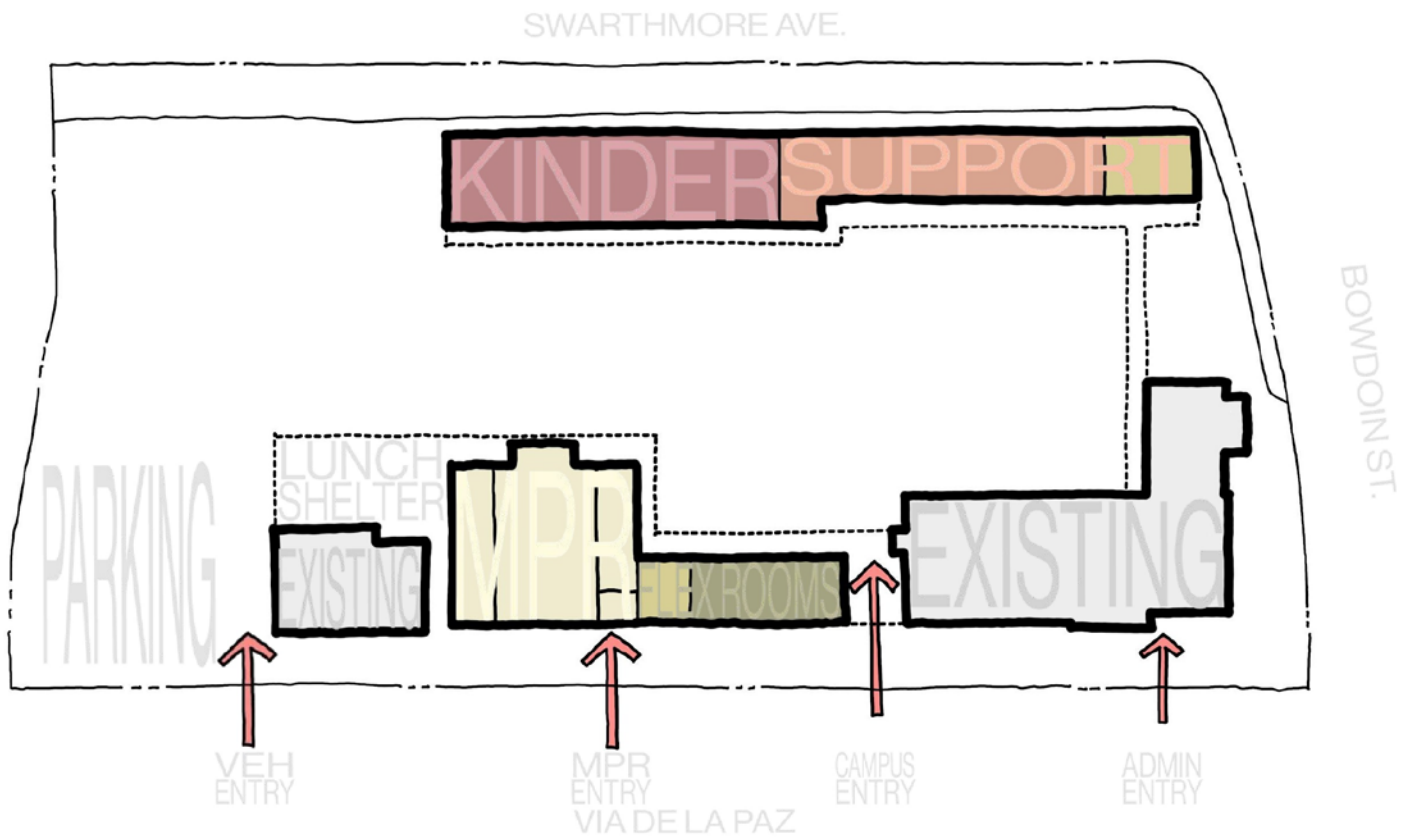

Scheme 01 - Ground Floor



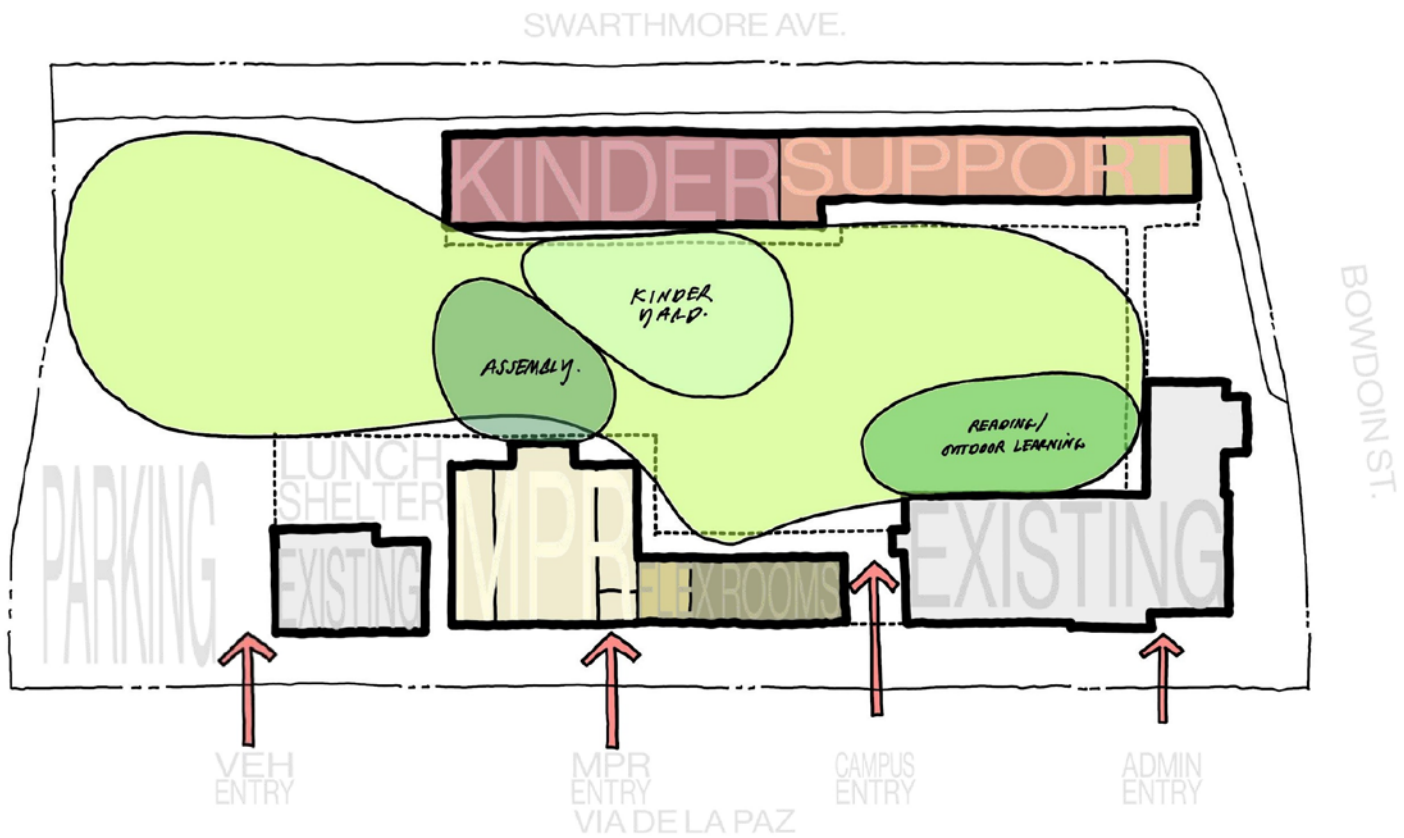

Scheme 01 - Ground Floor



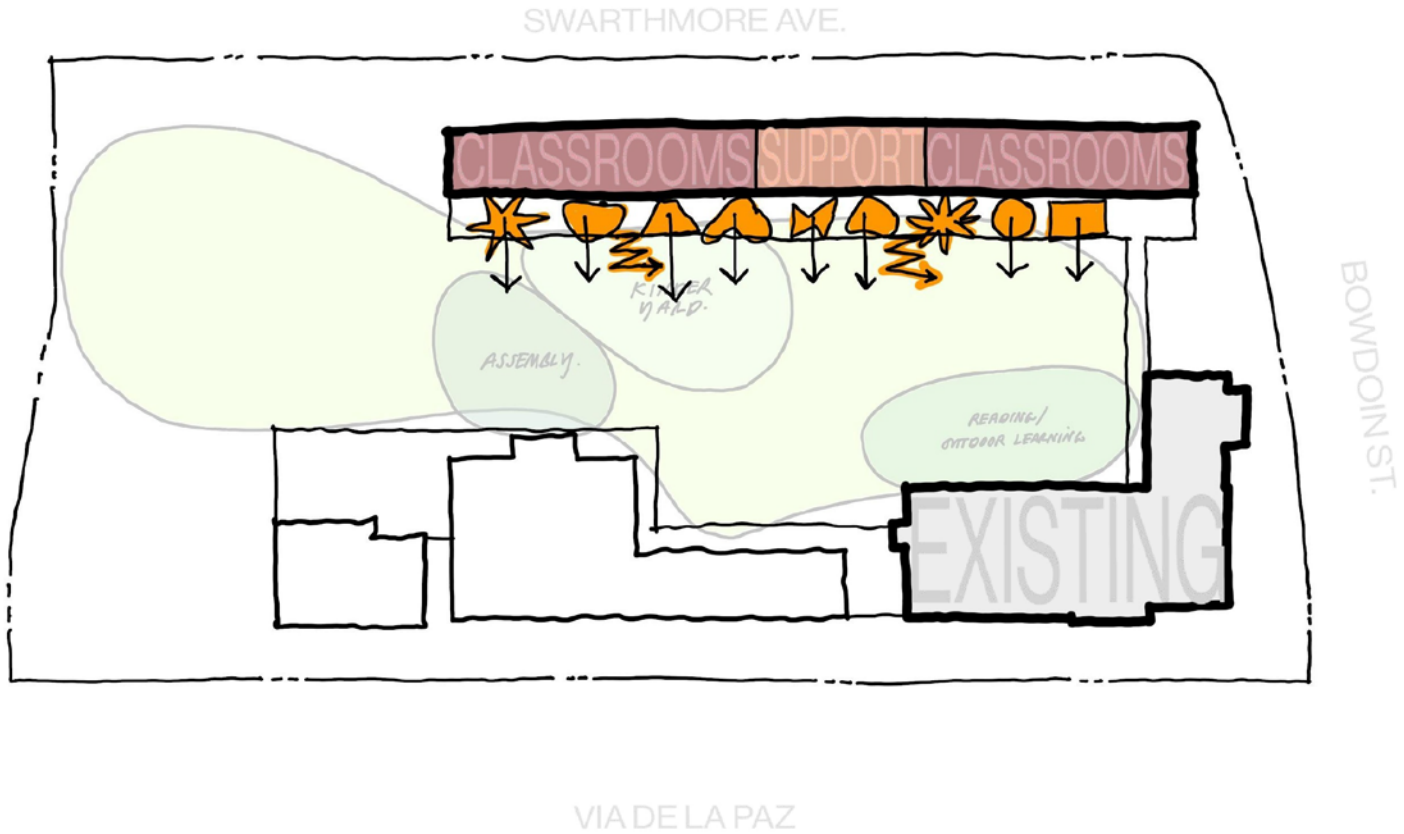

Scheme 01 - Second Floor



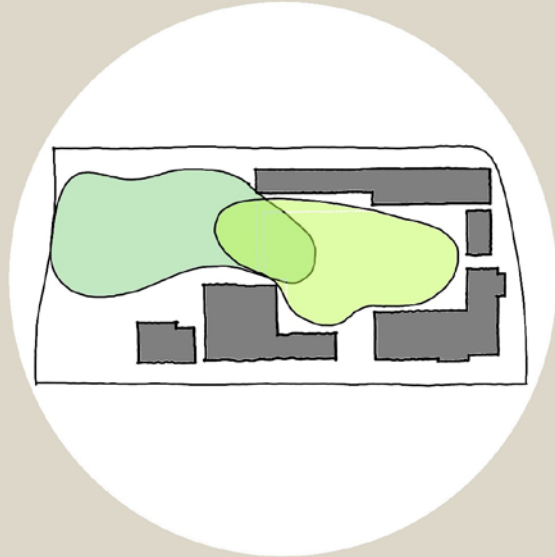

Scheme 02

Interwoven Landscapes

2-Story L-Shaped Building

Differentiate Open Space

MPR and Elementary Entry along Via De La Paz

Kindergarten Entry Along Bowdoin



Scheme 02 Inspirational Images

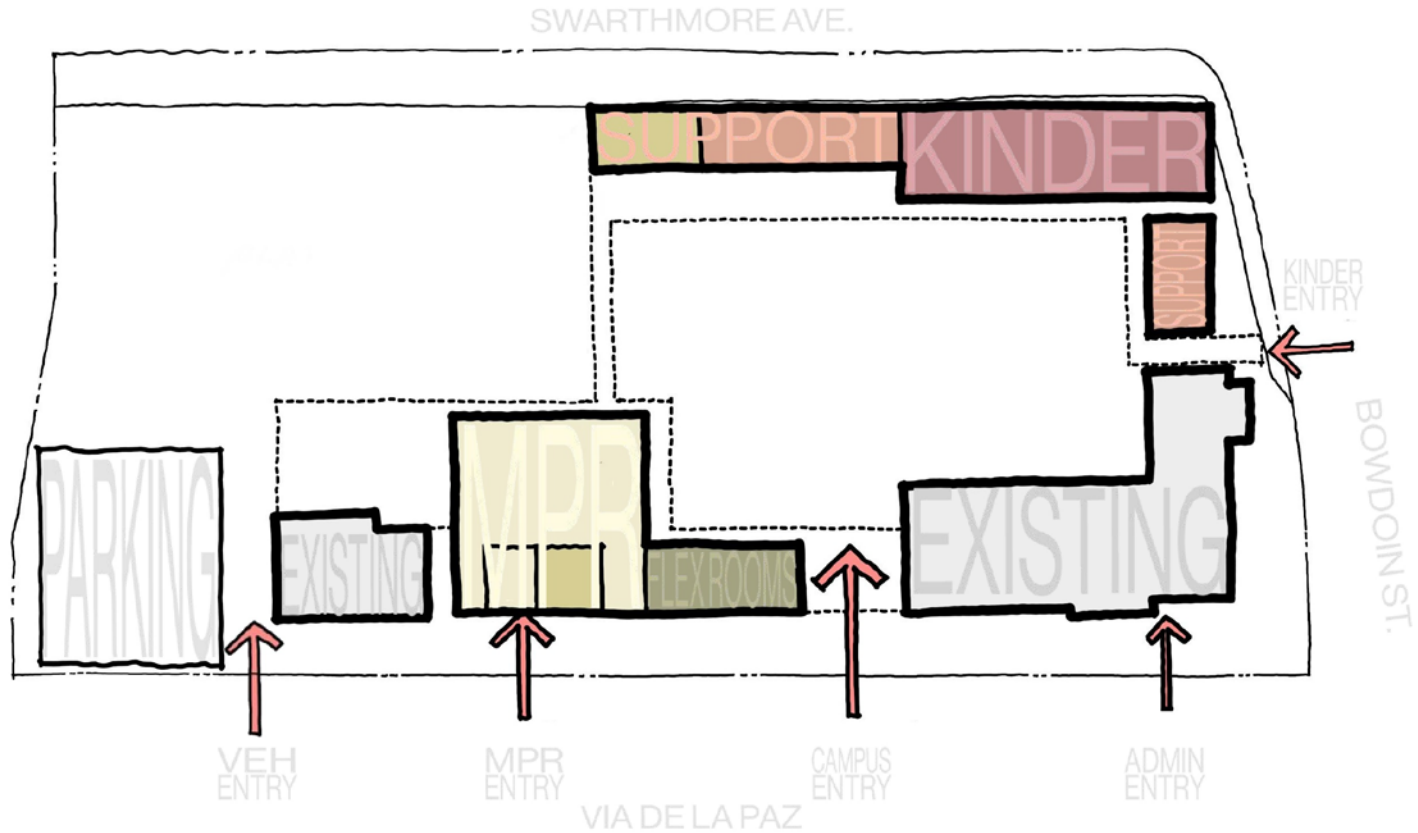

Scheme 02 (Interwoven Landscapes) - Ground Floor

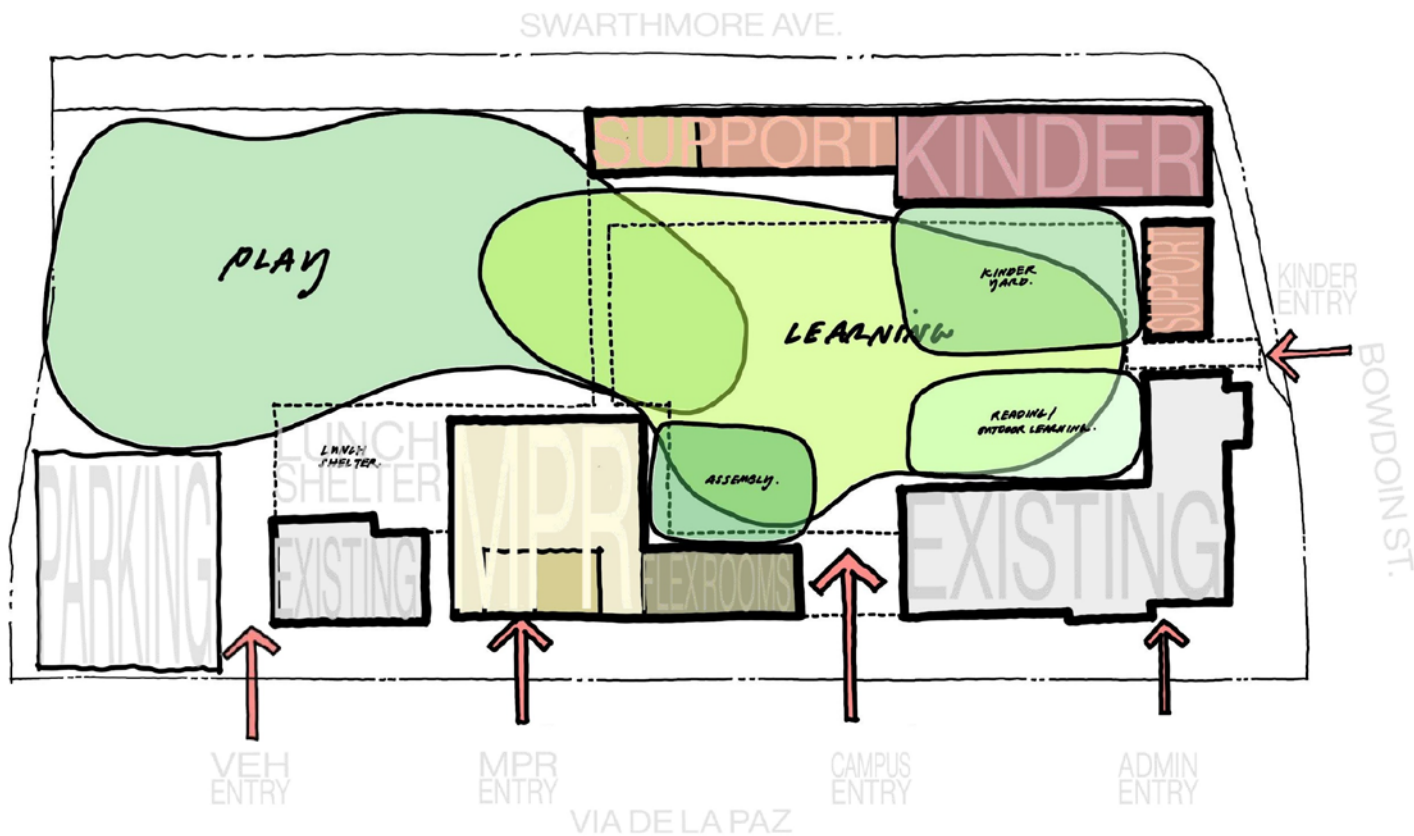

Scheme 02 (Interwoven Landscapes) - Ground Floor



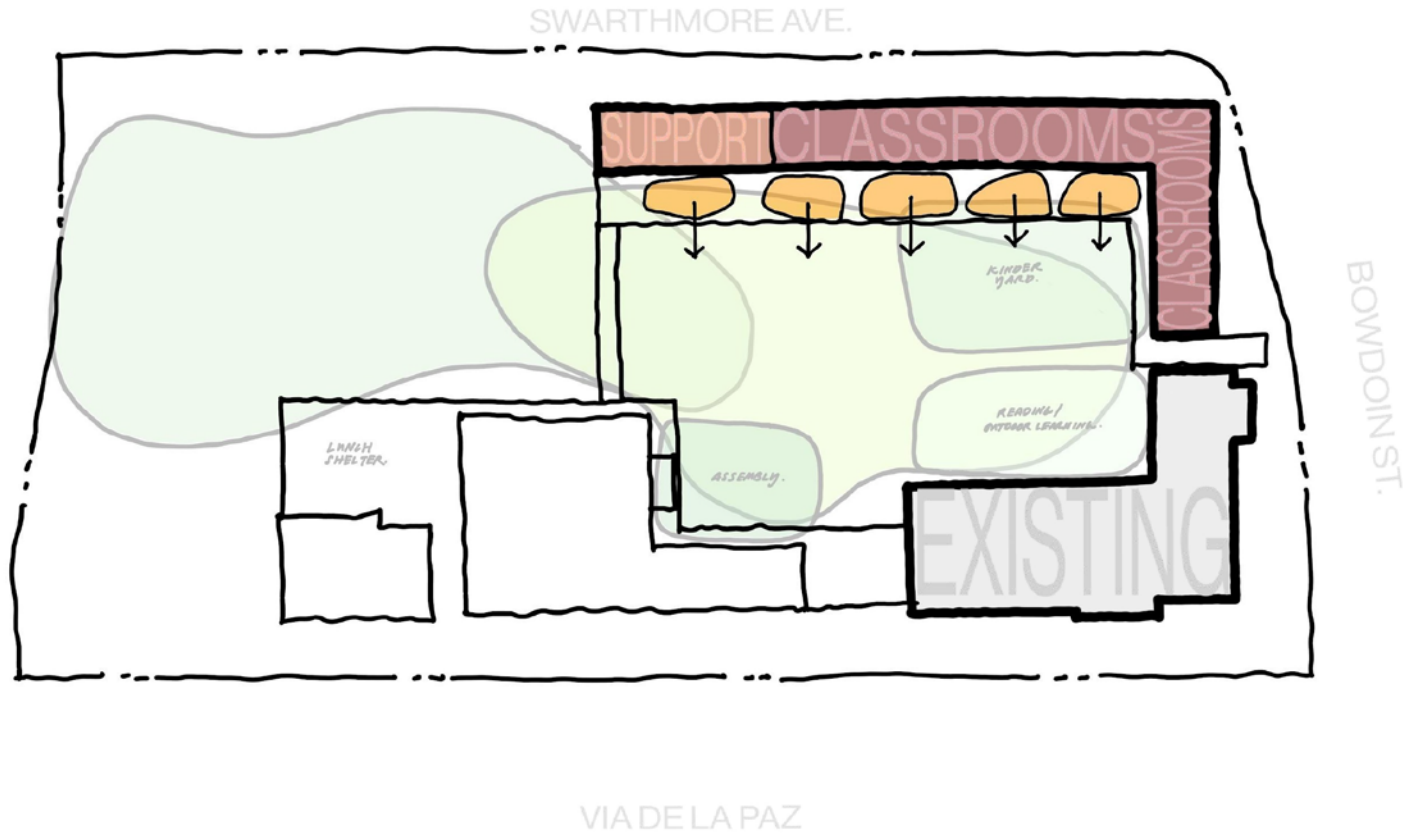

Scheme 02 (Interwoven Landscapes) Second Floor

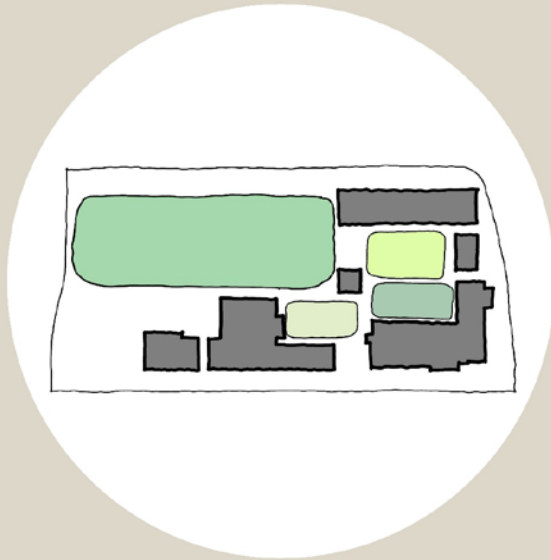

Scheme 03

Garden Courts

2-Story Courtyard Building

Variety of Open Spaces

MPR and Elementary Entry along Via De La Paz

Kindergarten Entry Along Bowdoin



Scheme 03 - Inspirational Images

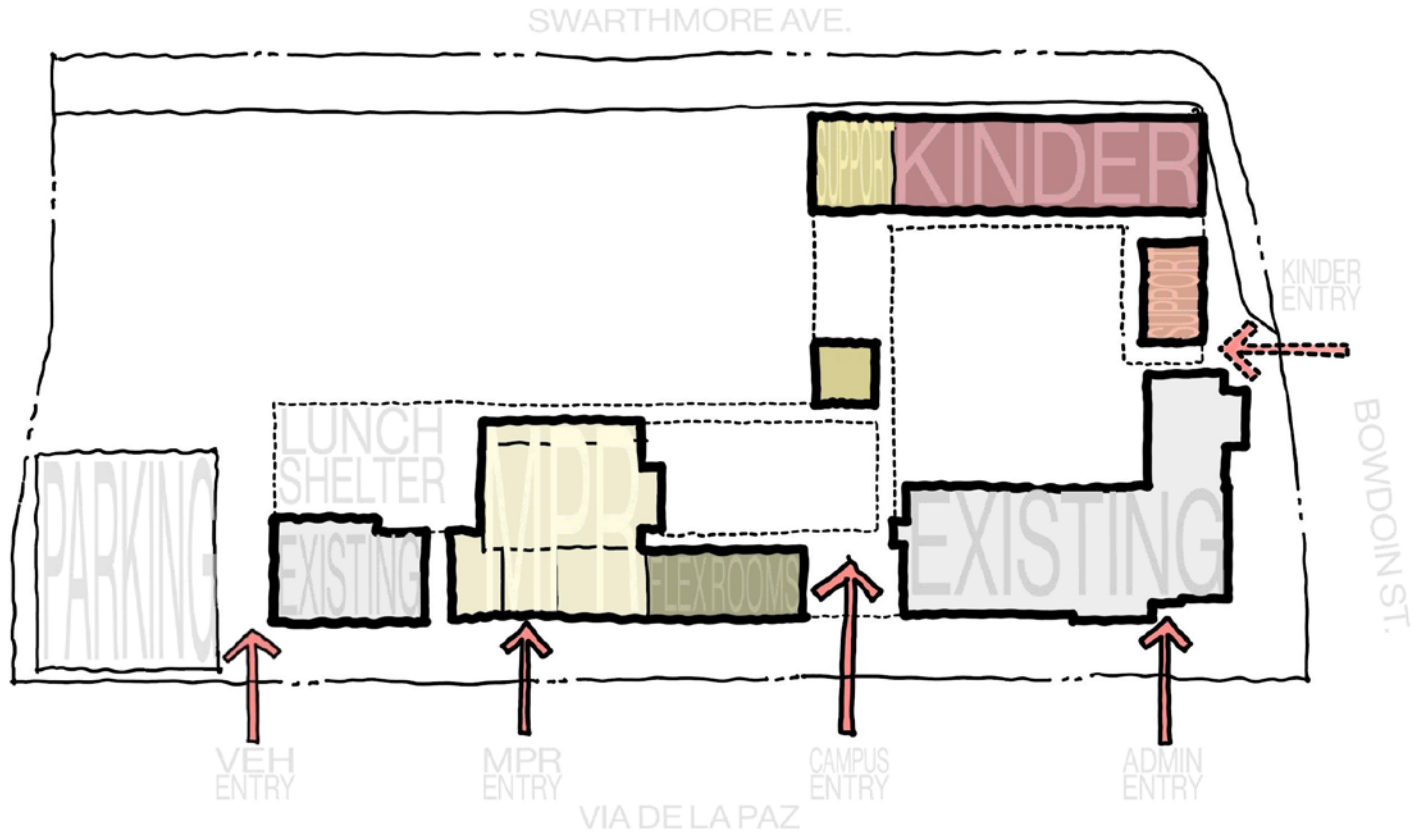

Scheme 03 - Ground Floor Plan



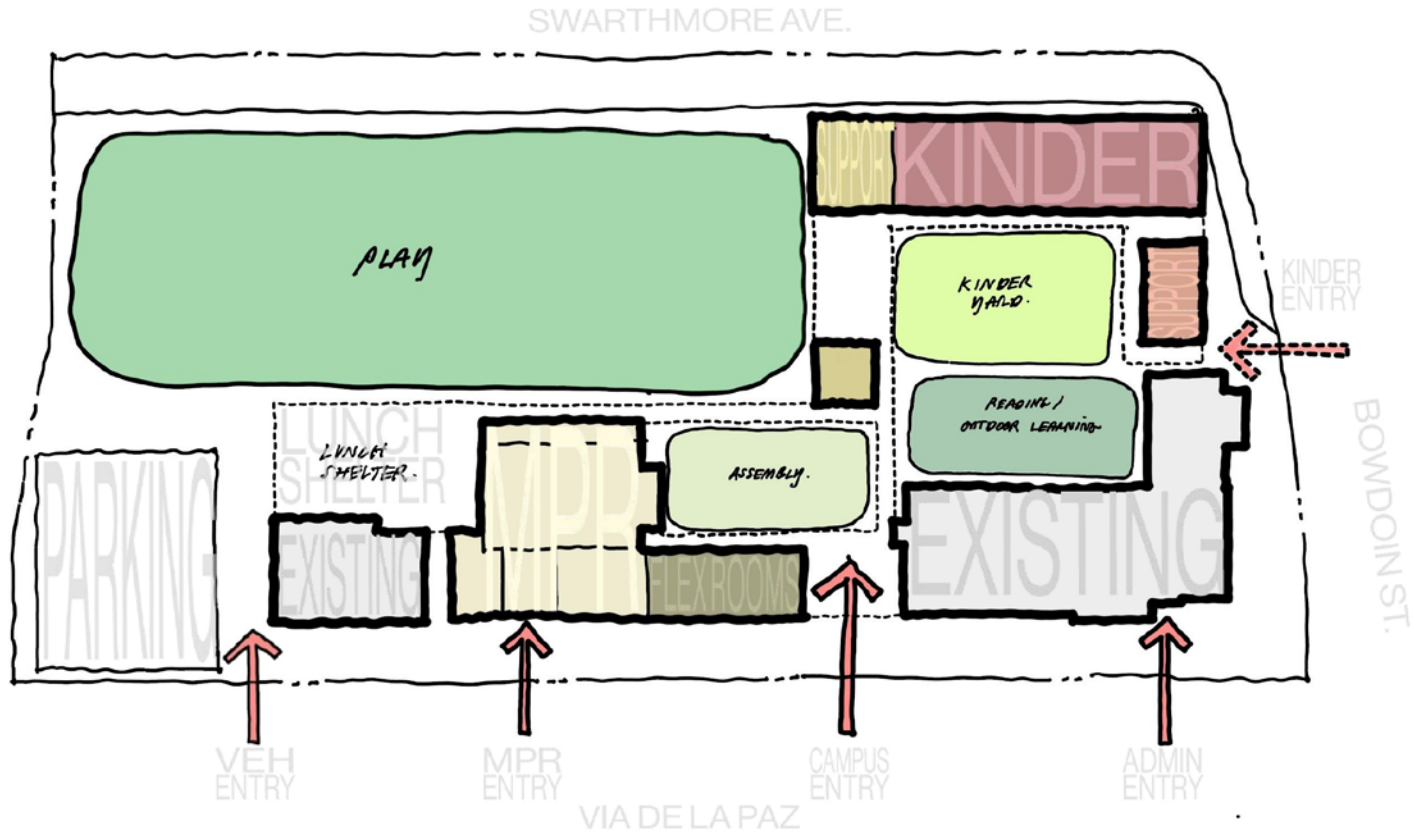

Scheme 03 - Ground Floor Plan



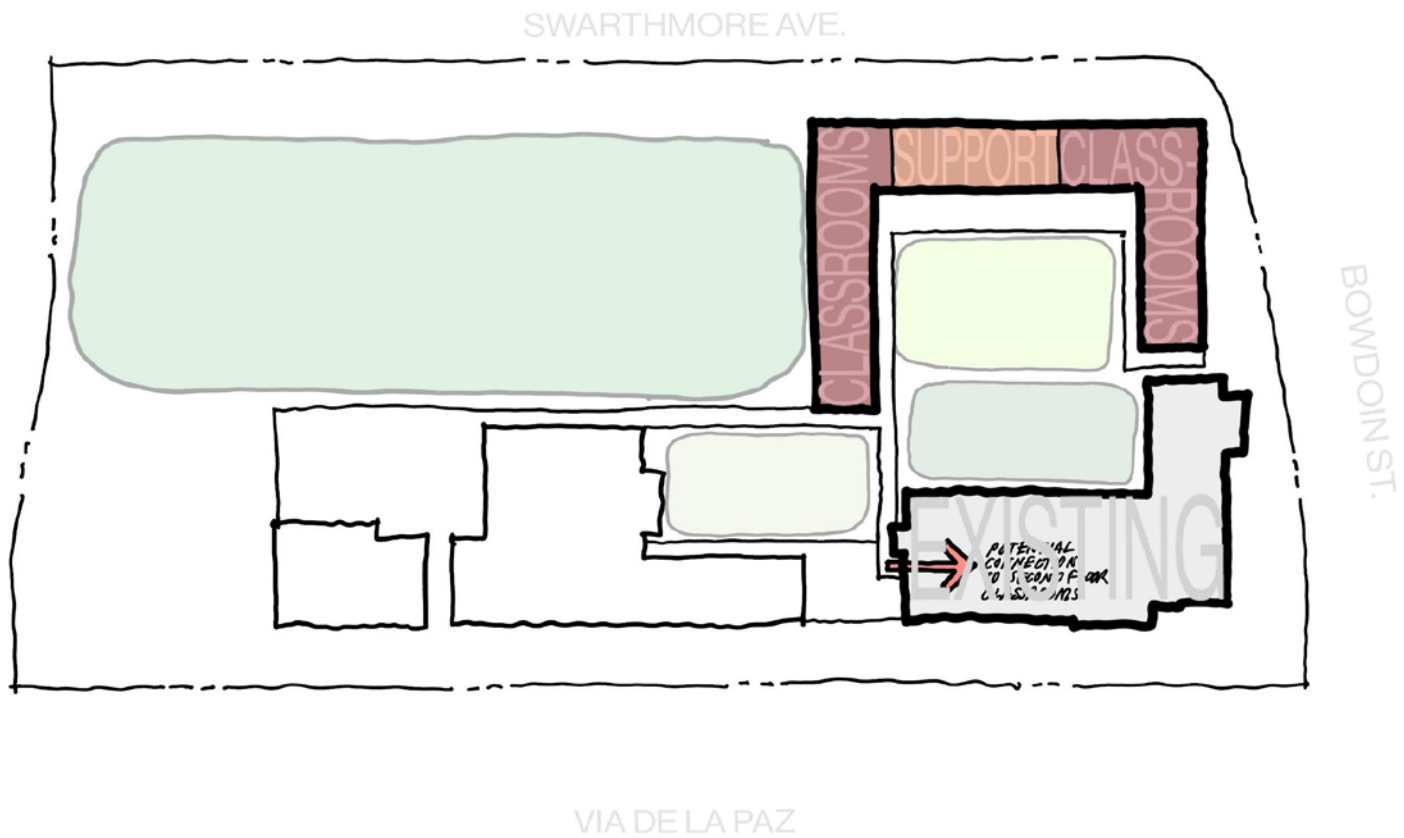

Scheme 03 - Second Floor Plan

1 - Community Commons

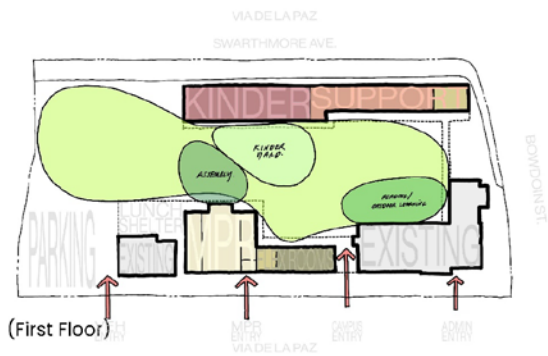
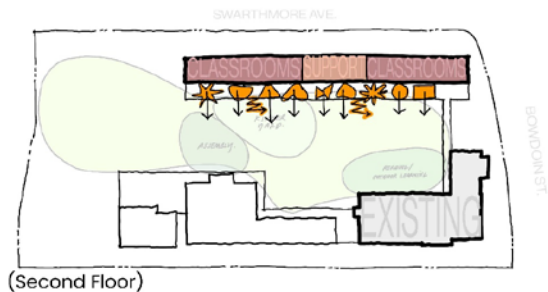

2 - Interwoven Landscapes

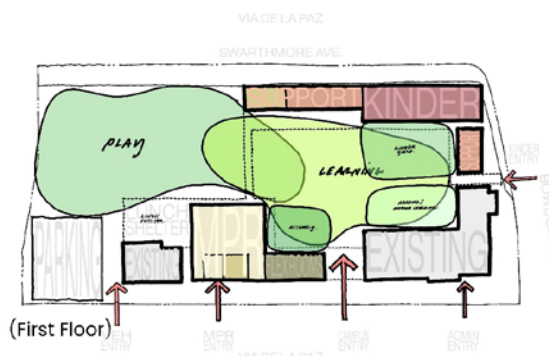
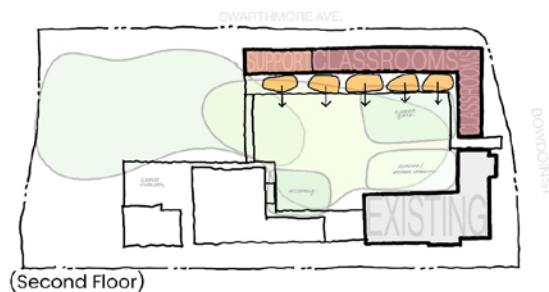

3 - Garden Courts

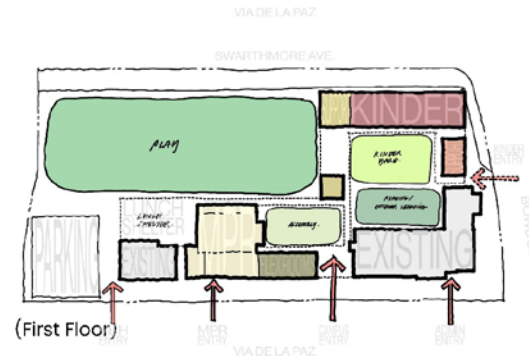
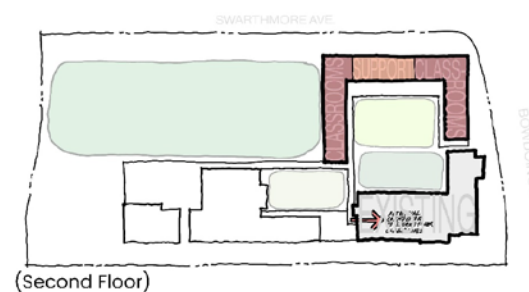

Submit questions by
scanning the QR code.



FSD Community Relations Department: 213-241-1340

community.relations@laschools.org

<https://www.lausd.org/facilities/community-relations>

Closing Remarks

We appreciate your interest, participation, and support as **unified** we move forward in rebuilding the Palisades community schools.

Should you have any questions, concerns, or wish to provide other input or feedback to Region West Operations, please send an email to:

FireRecoveryWest@lausd.net

Should you have any questions, concerns, or wish to provide other input or feedback to Facilities reconstruction projects, please send an email to:

community.relations@laschools.org

Thank
you!